

## Features

- General Purpose Motors
- Maximum Oil Temp.: 180°F (82°C)
- Seven precision machined rollers provide rolling contact support. Rollers reduce friction for increased efficiency & extended motor life.



## Technical Data

TYPE		HMS050	HMS080	HMS160	HMS200	HMS250	HMS400
Displacement: in <sup>3</sup> ./ rev.		3.15	4.91	9.80	12.25	15.41	24.52
Maximum Speed: rpm	cont.	775	750	375	300	240	160
Maximum Torque: in/ lbs	cont.	823	1345	2743	3266	3363	3363
	int.	1044	1673	3346	3983	4160	4160
Maximum Pressure: psi	cont.	2031	2031	2031	2031	1595	1015
	int.	2538	2538	2538	2538	2031	1305
Maximum Flow: gpm	cont.	10.6	15.9	15.9	15.9	15.9	16.0
Maximum Output: hp	cont.	9	13	13	11	8	5
Weight: lbs (kgs)		14 (6.35)	15 (6.80)	17 (7.71)	18 (8.17)	19 (8.62)	24 (10.89)

## Dimensional Data

Units: mm (inches)

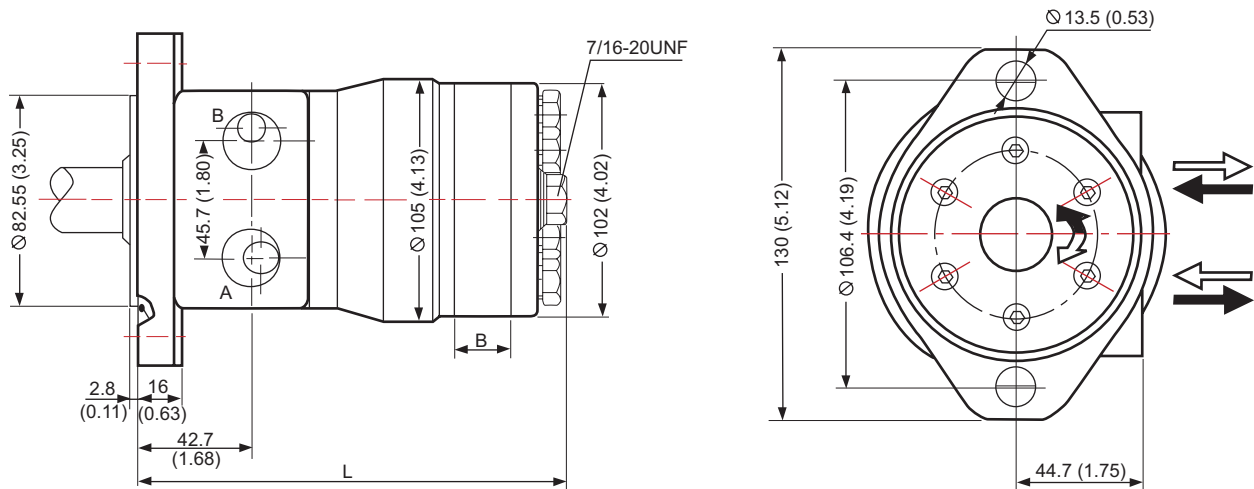

TYPE	HMS 050	HMS 080	HMS 160	HMS 200	HMS 250	HMS 400
L	149.1 (5.87)	153.9 (6.06)	167.9 (6.61)	175.0 (6.89)	183.9 (7.24)	210.1 (8.27)
B	8.9 (0.35)	14.0 (0.55)	27.9 (1.10)	35.1 (1.38)	43.9 (1.73)	70.1 (2.76)

## Performance Curves

**HMS050**

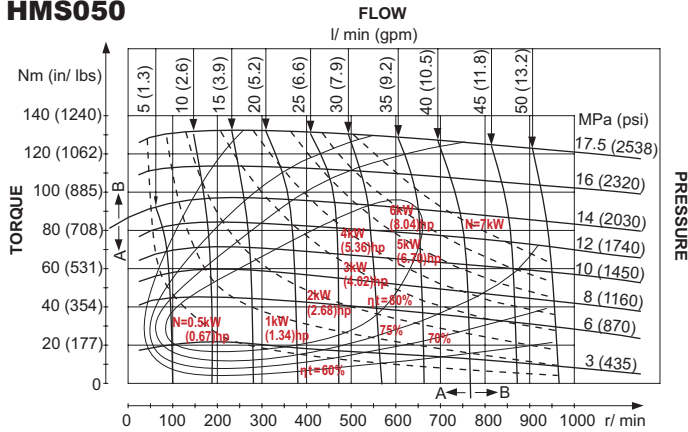

**HMS080**

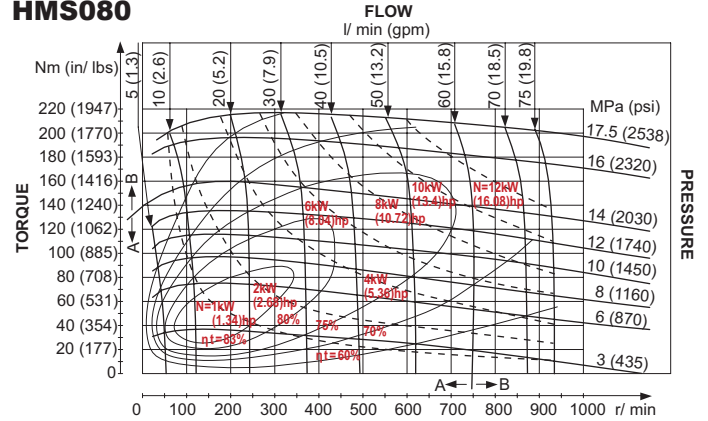

**HMS160**

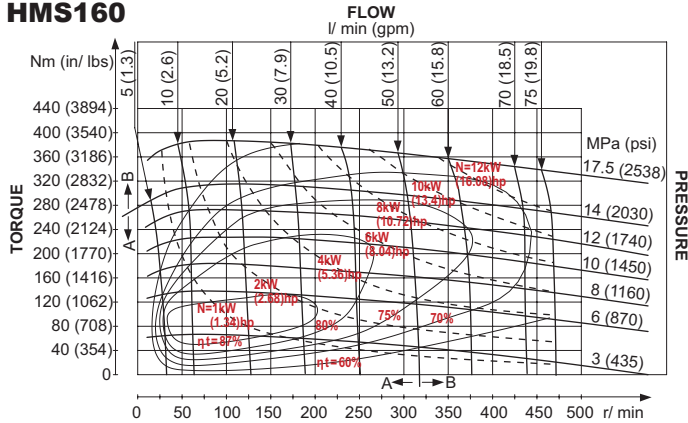

**HMS200**

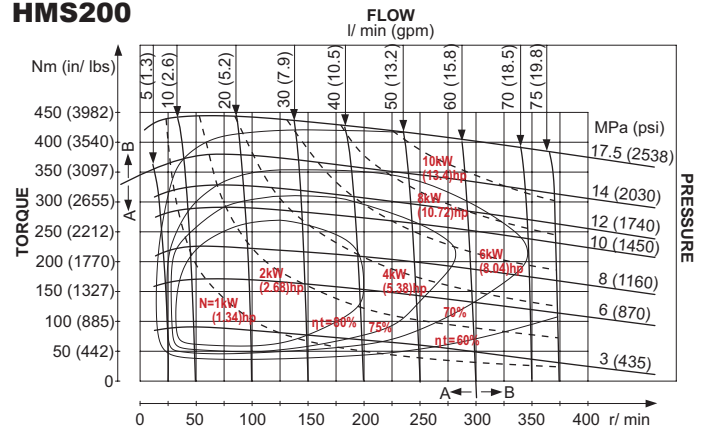

**HMS250**

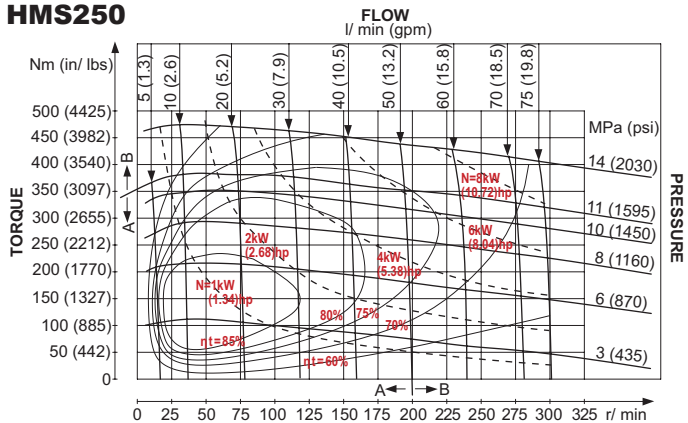

**HMS400**

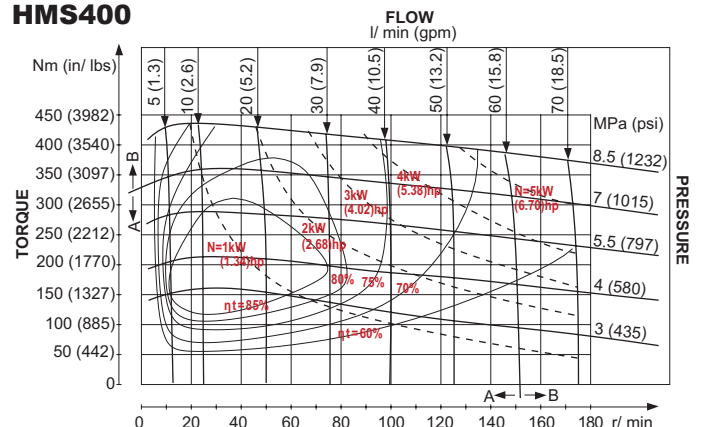

## Ordering Information

### HMS - 050 - B2 K S

**HMS Series**  
Orbital  
Hydraulic  
Motor

**Displacement**  
(in<sup>3</sup>/rev.)

**050 200**  
**080 250**  
**160 400**

**Mounting Flange**

**B2=** SAE-A, 2 Bolt,  
Pilot 3.25"

**B4=** SAE-A, 4 Bolt,  
Pilot 1.75"

**Shaft**

**K=** 1" Straight Key  
x 1/4" Key

**S=** 1" Splined  
SAE 6B

**Port**

**S=** 7/8-14 UNF  
O-Ring

**P=** 1/2-14 NPTF

### STOCK MOTORS

- HMS - 050 - B4KP
- HMS - 050 - B2KS
- HMS - 080 - B2KP
- HMS - 160 - B2KP
- HMS - 160 - B4KS
- HMS - 200 - B2KS
- HMS - 250 - B2KP
- HMS - 400 - B2SS