

# FLUID POWER DATA

## SAE O-RING PORT DIMENSIONS

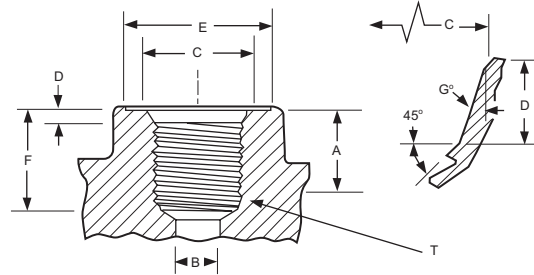

### SAE O-RING PORT DIMENSIONS



PORT DIMENSIONS												FITTING DIMENSIONS				
SIZE		STRAIGHT THREAD "T"			A	B	C	D	E	F	G	SAE HEX BOSS		AND HEX BOSS		O-RING
NOMINAL TUBE OD	TUBE DASH NO.	SIZE	PITCH DIAM.	MINOR DIAM.	MIN. THREAD DEPTH	MIN DIAM.	+0.005 -0.000 DIAM.	+0.015 -0.000	MIN. DIAM.	MIN.	±1°	ACROSS FLATS	ACROSS CORNERS	ACROSS FLATS	ACROSS CORNERS	
1/8	-2	5/16-24	.2854 .2902	.267 .277	.390	.062	.358	.074	.672	.468	12°	.44	.51	.56	.64	-902
3/16	-3	3/8-24	.3479 .3528	.330 .340	.390	.125	.421	.074	.750	.468	12°	.50	.58	.63	.72	-903
1/4	-4	7/16-20	.4050 .4104	.383 .395	.454	.172	.487	.093	.828	.547	12°	.56	.64	.69	.80	-904
5/16	-5	1/2-20	.4765 .4731	.446 .457	.454	.234	.550	.093	.906	.547	12°	.63	.72	.75	.86	-905
3/8	-6	9/16-18	.5264 .5323	.502 .515	.500	.297	.616	.097	.969	.609	12°	.69	.80	.81	.94	-906
1/2	-8	3/4-16	.7094 .7159	.682 .696	.562	.391	.811	.100	1.188	.688	15°	.88	1.02	1.00	1.16	-908
5/8	-10	7/8-14	.8286 .8356	.798 .814	.656	.484	.942	.100	1.344	.781	15°	1.00	1.16	1.13	1.30	-910
3/4	-12	1 1/16-12	1.0084 1.0158	.972 .990	.750	.609	1.148	.130	1.625	.906	15°	1.25	1.45	1.38	1.59	-912
7/8	-14	1 3/16-12	1.1334 1.1409	1.097 1.115	.750	.719	1.273	.130	1.765	.906	15°	1.38	1.59	1.50	1.73	-914
1	-16	1 5/16-12	1.2584 1.2659	1.222 1.240	.750	.844	1.398	.130	1.910	.906	15°	1.50	1.73	1.63	1.88	-916
1 1/4	-20	1 5/8-12	1.5709 1.5785	1.535 1.553	.750	1.078	1.713	.132	2.270	.906	15°	1.88	2.17	1.94	2.24	-920
1 1/2	-24	1 7/8-12	1.8209 1.8287	1.785 1.803	.750	1.312	1.962	.132	2.560	.906	15°	2.13	2.45	2.19	2.53	-924
2	-32	2 1/2-12	2.4459 2.4540	2.410 2.428	.750	1.781	2.587	.132	3.480	.906	15°	2.75	3.17	2.81	3.45	-932