

PCP16/ 21

### Specifications

**PCP16** 1800 rpm, 16.6 gpm (at no load), 3000 psi max

Model	Pressure Range (psi)	Displacement per rev.	Flow @1800 rpm	Weight
PCP16-.5K-2BK-2	143-500	2.14 cu-in 35.0 cc	16.6 gpm (63.0 lpm)	51.0 lbs 23.0 kgs
PCP16-1K-2BK-2	286-1000			
PCP16-2K-2BK-2	500-2000			
PCP16-3K-2BK-2	500-3000			

### Performance Data

Typical performance curves based on ISO VG32 Oil @ 120°F, (49°C)

#### Efficiency Curves

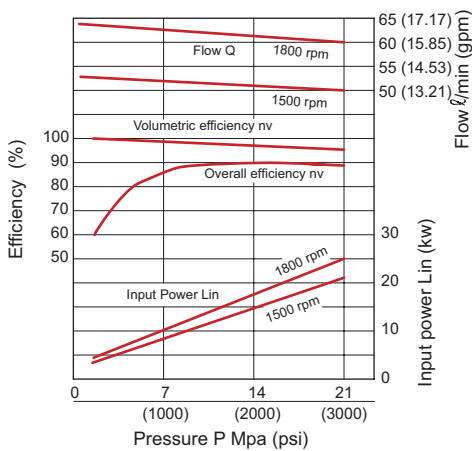

#### Pressure vs Flow

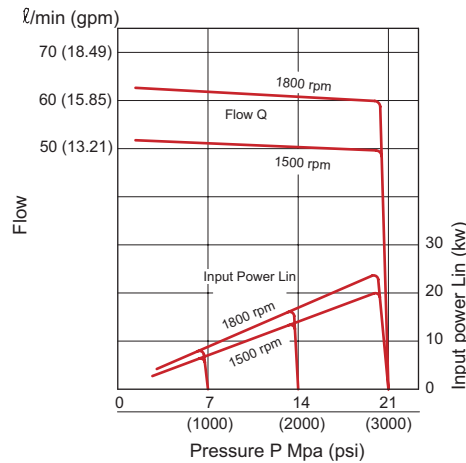

#### Power Input

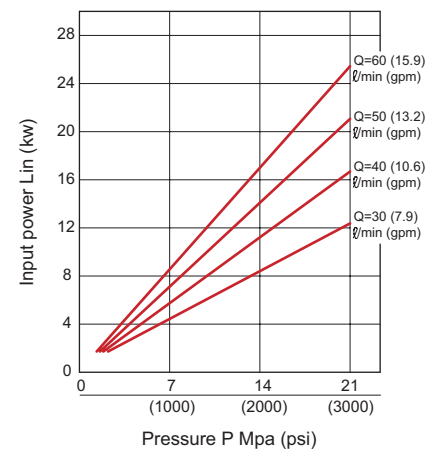

#### Deadhead Power

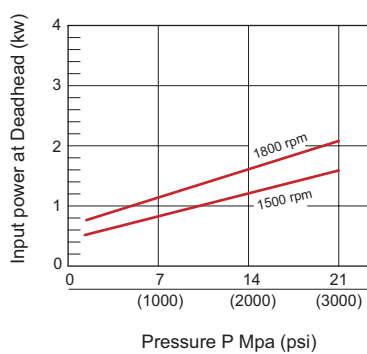

#### Noise Level

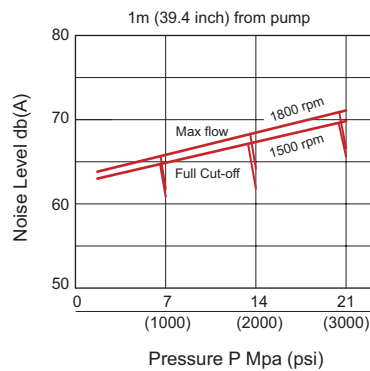

#### Drain Curve

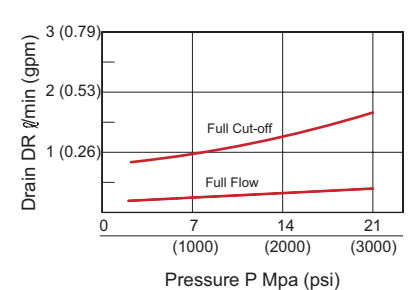

### Specifications

**PCP21** 1800 rpm, 21.5 gpm (at no load), 3000 psi max

Model	Pressure Range (psi)	Displacement per rev.	Flow @1800 rpm	Weight
PCP21-.5K-2BK-2	143-500	2.76 cu-in 45.0 cc	21.5 gpm (81.0 lpm)	51.0 lbs 23.0 kgs
PCP21-1K-2BK-2	286-1000			
PCP21-2K-2BK-2	500-2000			
PCP21-3K-2BK-2	500-3000			

### Performance Data

Typical performance curves based on ISO VG32 Oil @ 120°F, (49°C)

#### Efficiency Curves

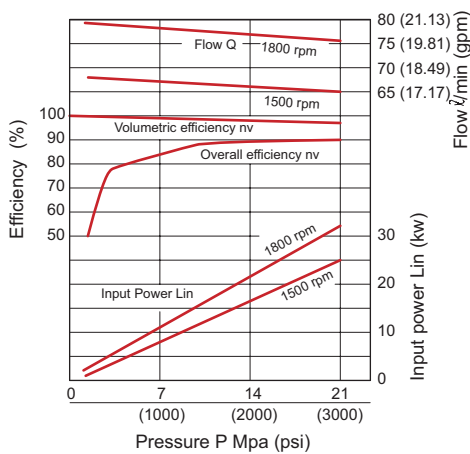

#### Pressure vs Flow

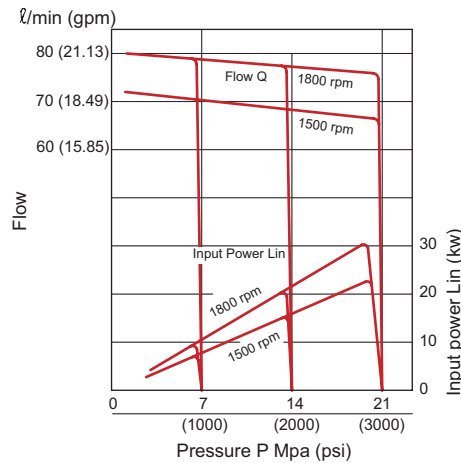

#### Power Input

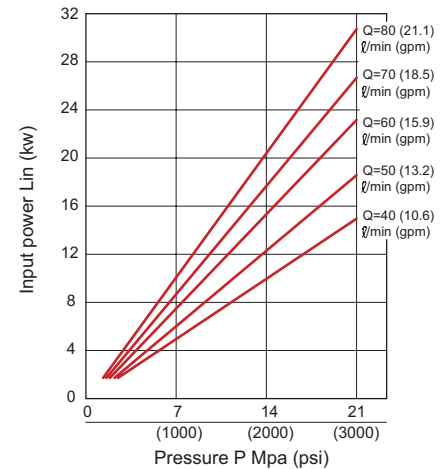

#### Deadhead Power

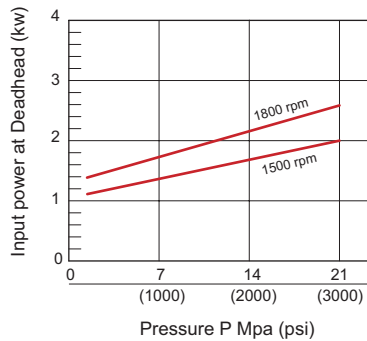

#### Noise Level

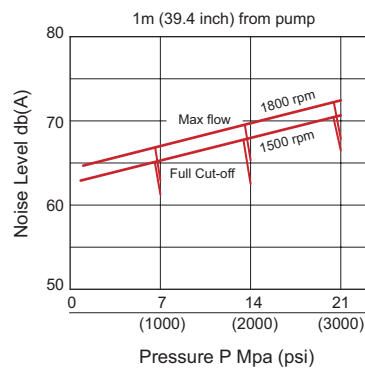

#### Drain Curve

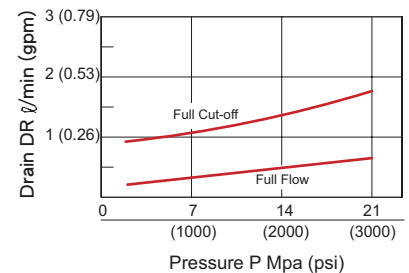

**Dimensional Data**

**PCP16/21-3K-2BK-2**

Units: mm (inches)  
Weight: 51.0 lbs/ 23.0 kgs

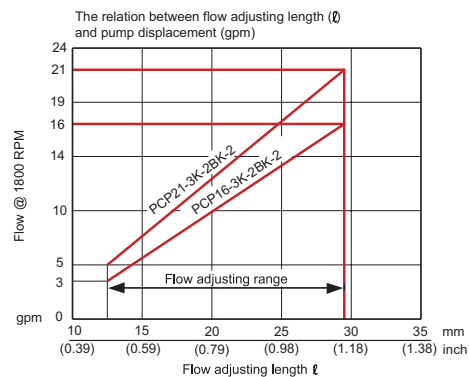
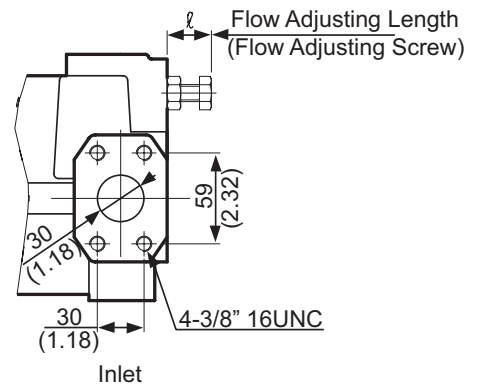
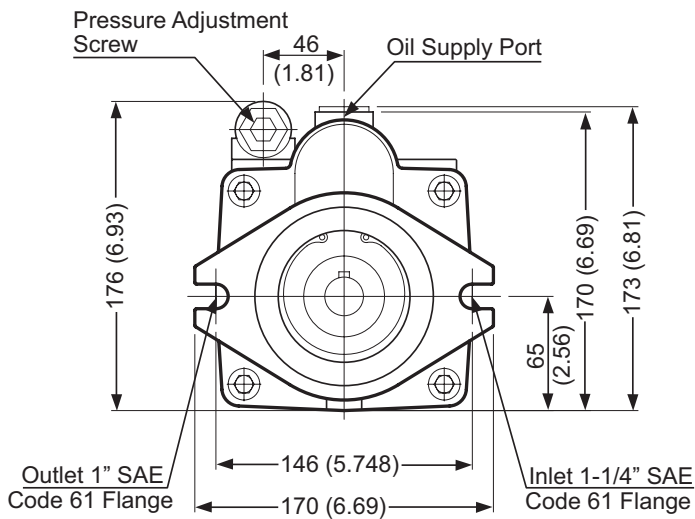
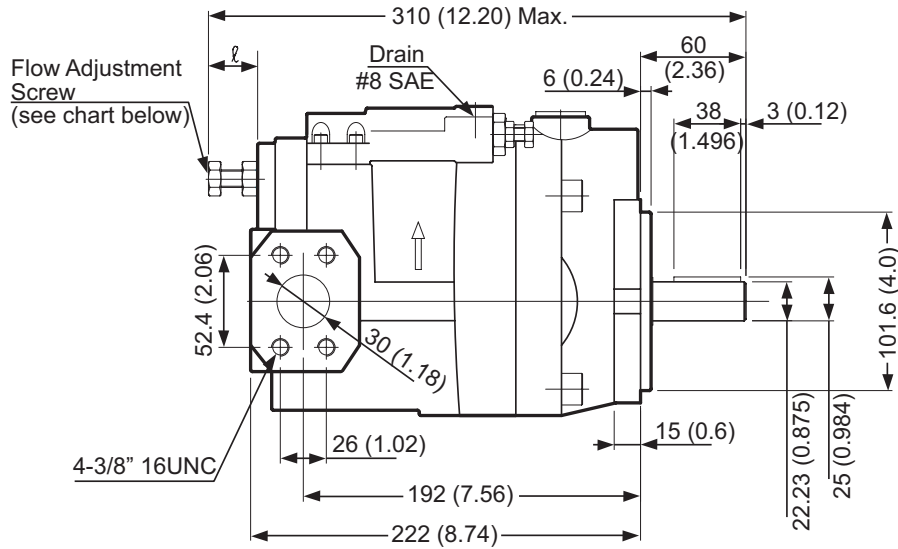

### Dimensional Data

#### PCP16/21-3K-2BK-2-LS

Units: mm (inches)  
Weight: 52.1 lbs/ 23.6 kgs

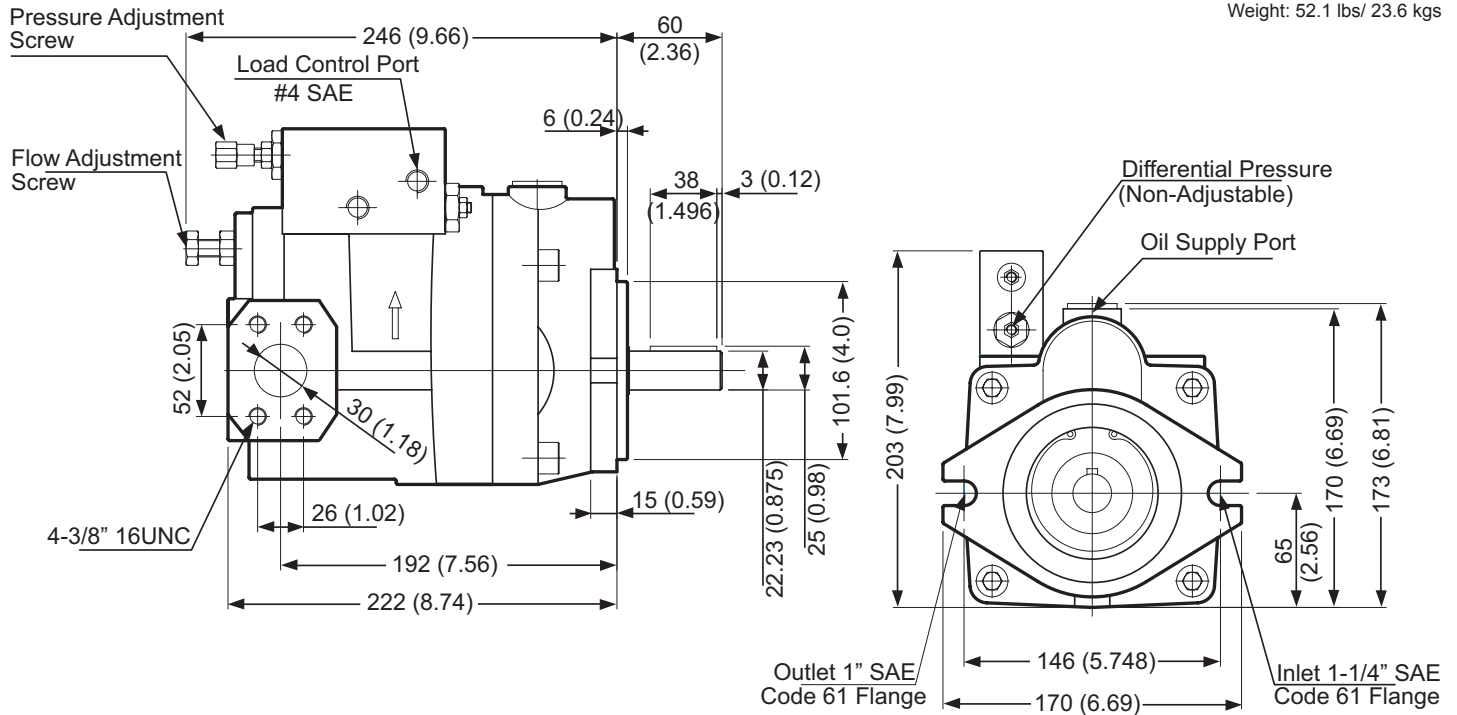

#### PCP16/21-3K-2BK-2-2PSO

Units: mm (inches)  
Weight: 59.1 lbs/ 26.8 kgs

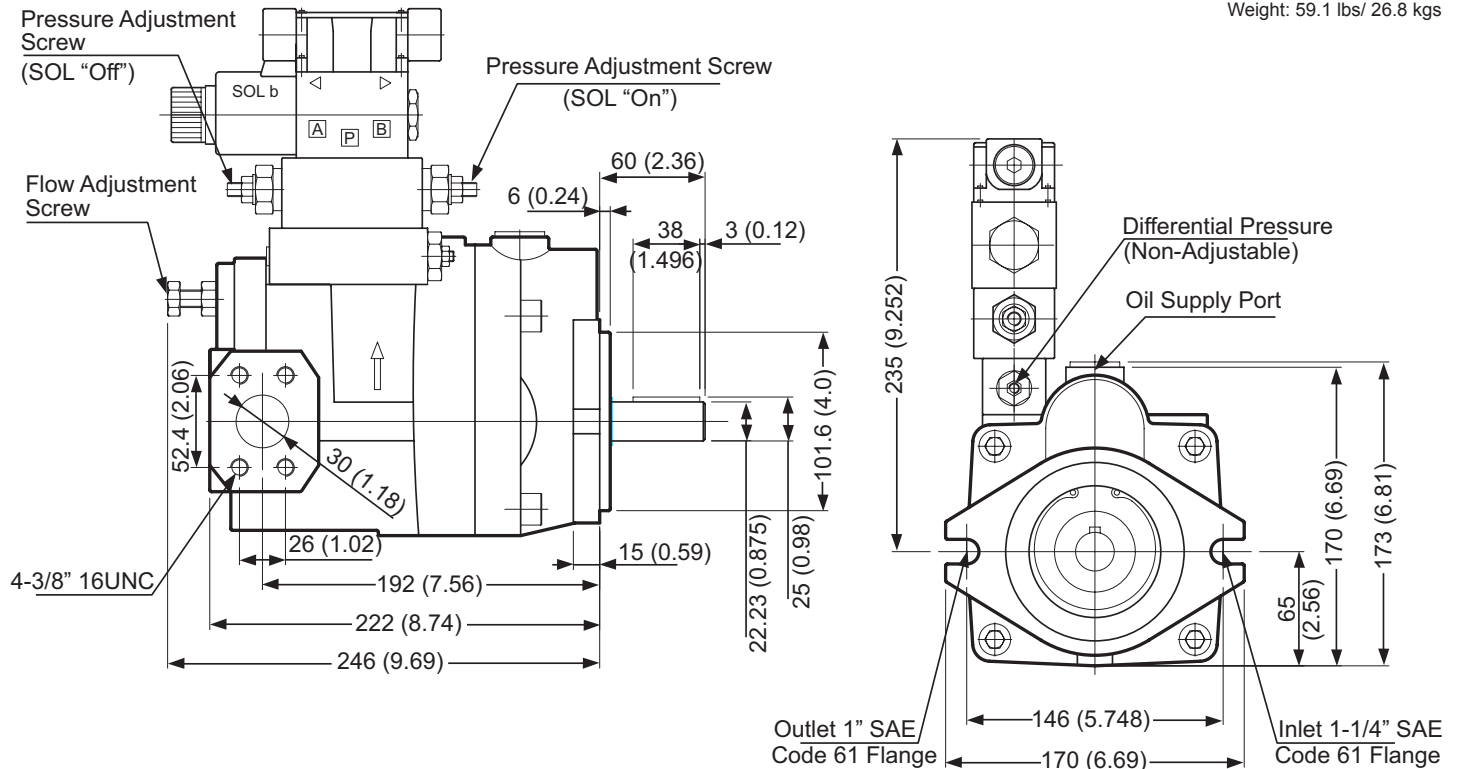

### Dimensional Data

#### PCP16/21-3K-2BK-2-RC

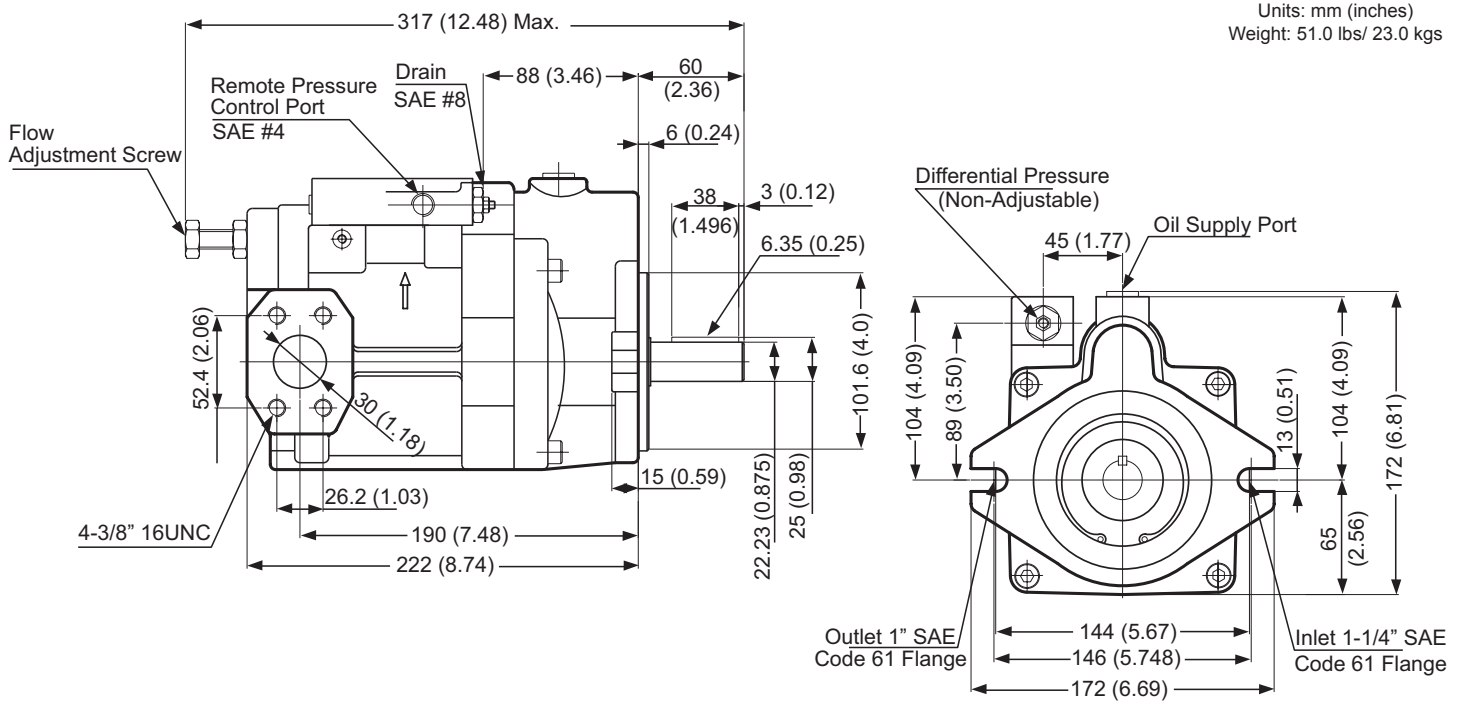

#### PCP16/21-3K-2BK-2-2P2F

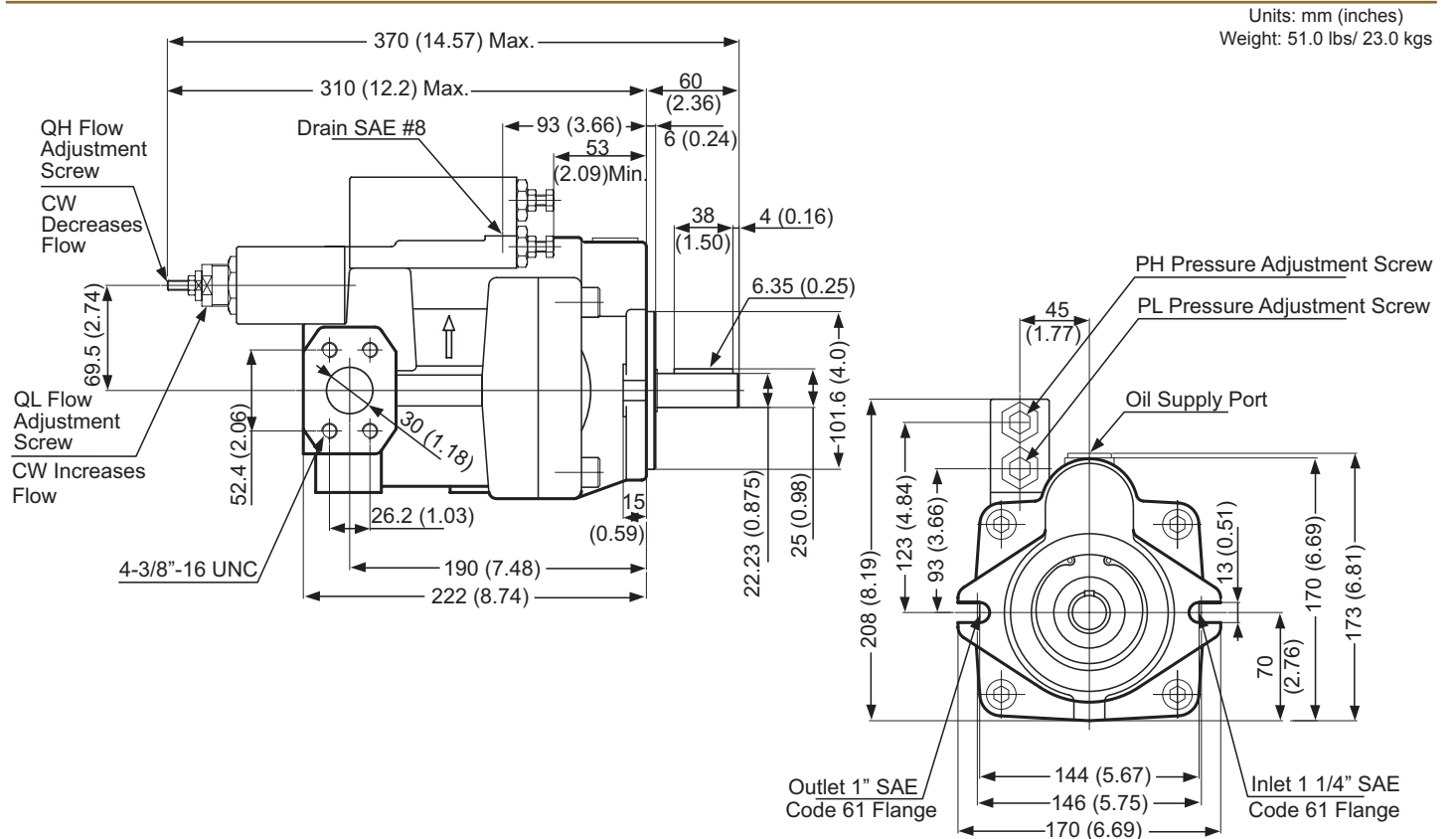

### Dimensional Data

#### PCP16/21-3K-2BK-2-SO

Units: mm (inches)  
Weight: 55.8 lbs/ 25.3 kgs

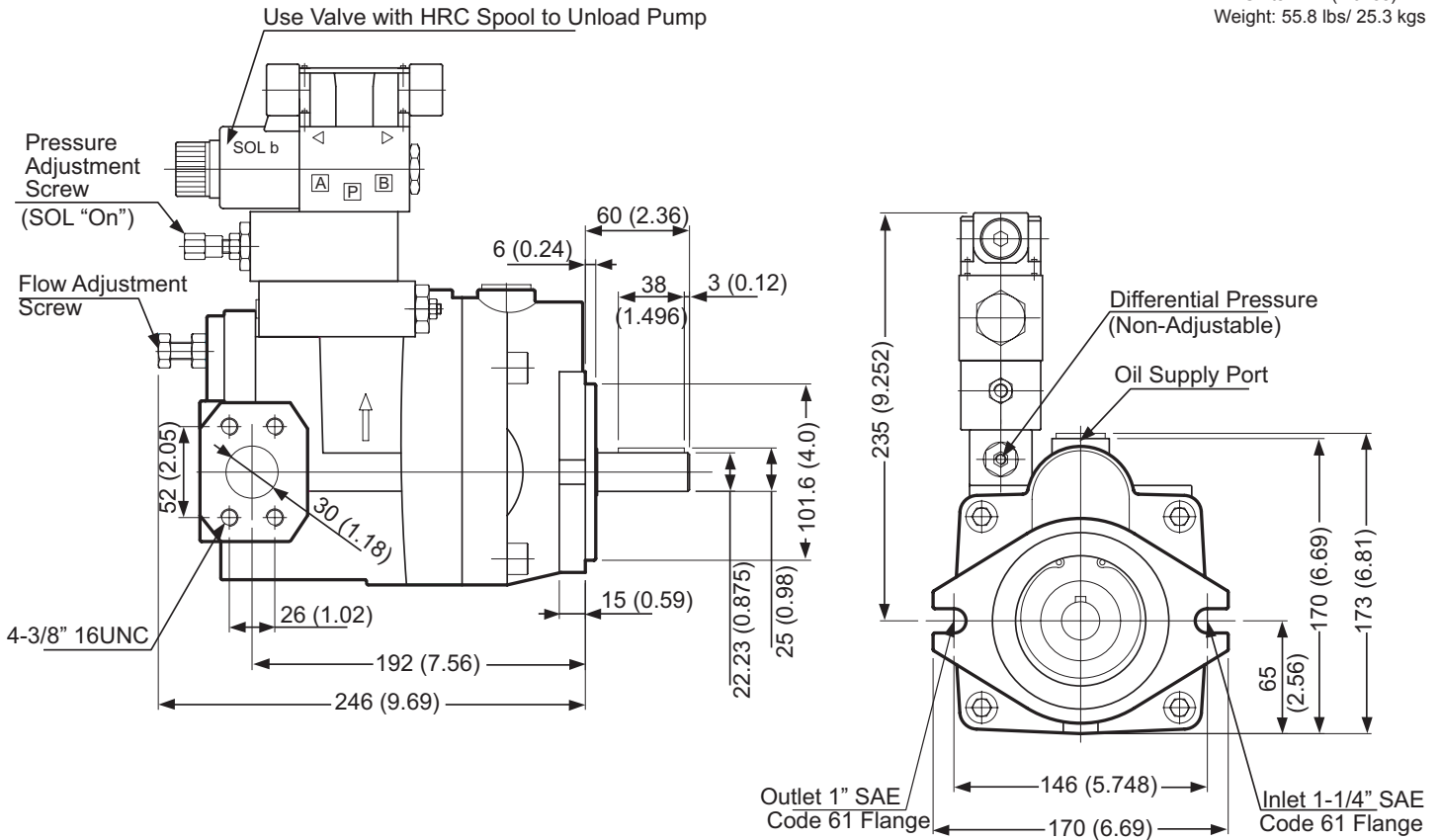

### Ordering Information

#### PCP16 - 3K - 2BK - 2 - LS

Note: Available right hand rotation (only)- viewed facing pump shaft

Size (GPM)	Pressure Range	Mounting Style	Series 2 Porting	Control Type
16	.5K= 143-500 psi	2BK= 2 Bolt, SAE B, 7/8" Dia. Keyed Shaft x 2.125" Long w/ 1/4" Key w/ Flow Adj.	Inlet- 1-1/4" SAE Code 61 Flange Outlet- 1" SAE Code 61 Flange Case Drain- #8 Female SAE	omit= Standard
21	1K= 286-1000 psi			RC= Remote Compensator
	2K= 500-2000 psi			LS= Load Sensing
	3K= 500-3000 psi			2PSO= Dual Pressure Solenoid
				SO= Single Pressure Solenoid
				2P2F= Two Pressure Two Flow